



\* **The RC-202 contains demo data (bank 8). If you erase this demo data, it cannot be recovered. Before you proceed, you should back it up as described in “Backing up to your computer” (p. 15).**

\* **The power to this unit will be turned off automatically after a predetermined amount of time has passed since it was last used for playing music, or its buttons or controls were operated (Auto Off function).**

- If you do not want the power to be turned off automatically, disengage the Auto Off function (p. 7).
- Any settings that you are in the process of editing will be lost when the power is turned off. If you have any settings that you want to keep, you should save them beforehand.
  - To restore power, turn the power on again (p. 7).

## Main Features

The RC-202 is a live performance tool that lets you record your vocal or guitar performance and then play it back instantly. You can maximize your live performance potential by layering sounds in real time.

- Input FX are provided for recording, letting you use effects such as pitch shifter or Lo-Fi to make your phrase loops even more diverse.
- Track FX are provided for the playback tracks, letting you enhance and develop your live performances by applying effects that simulate changing the rotational speed of a turntable or the “stuttering” created by repeated notes on a sampler.
- You can combine your realtime recording with a loop phrase that you recorded beforehand. WAVE files from your computer can also be loaded as loop phrases.

### Owner's Manual (this document)

Read this first. It explains the basic things you need to know in order to use the RC-202.

### PDF Manual (download from the Web)

- **Parameter Guide (English)**  
This explains the parameters of the RC-202, and lists the built-in rhythm patterns.

### To obtain the PDF manual

**1. Enter the following URL in your computer.**

**<http://www.boss.info/manuals/>**



**2. Choose “RC-202” as the product name.**



# Contents

<b>Main Specifications</b> .....	<b>2</b>	<b>Bank Settings</b> .....	<b>12</b>
<b>Overview of the RC-202</b> .....	<b>3</b>	Saving a Bank .....	<b>12</b>
<b>Basic Operation Guide</b> .....	<b>4</b>	<b>Settings for the Entire RC-202 (System Settings)</b> <b>13</b>	
Specifying How Overdubbing Occurs.....	<b>4</b>	Adjusting the Output Volume of the OUTPUT Jacks and the Headphones .....	<b>13</b>
Setting the Tempo .....	<b>4</b>	Restoring the Factory Settings (Factory Reset) .....	<b>13</b>
Sounding a Rhythm .....	<b>4</b>	<b>Connecting to Your Computer via USB</b> .....	<b>14</b>
Recording/Playback/Overdub/Clear .....	<b>4</b>	Installing the USB Driver .....	<b>14</b>
Setup.....	<b>4</b>	Connecting the RC-202 to a Computer .....	<b>14</b>
Adjusting the Input Level .....	<b>4</b>	USB Function Settings .....	<b>14</b>
Selecting a Phrase Memory and Bank.....	<b>5</b>	Using USB to Exchange Files with Your Computer (USB Mass Storage).....	<b>14</b>
Display .....	<b>5</b>	<b>Connecting an External MIDI Device</b> .....	<b>16</b>
Track Settings .....	<b>5</b>	About MIDI Connectors.....	<b>16</b>
Saving a Phrase Memory.....	<b>5</b>	MIDI Settings.....	<b>16</b>
Input FX, Track FX .....	<b>5</b>	Controlling an External MIDI Device from the RC-202 .....	<b>16</b>
Connections .....	<b>6</b>	Controlling the RC-202 from an External MIDI Device .....	<b>17</b>
Adjusting the Input Level.....	<b>6</b>	Connecting Two RC-202 Units .....	<b>17</b>
Connecting to External Pedals .....	<b>6</b>	<b>Troubleshooting</b> .....	<b>18</b>
Turning On the Power .....	<b>7</b>	Error Message List.....	<b>19</b>
Auto Off Settings .....	<b>7</b>	<b>USING THE UNIT SAFELY</b> .....	<b>20</b>
Phantom Power Setting .....	<b>7</b>	<b>IMPORTANT NOTES</b> .....	<b>20</b>
Example of Actual Loop Recording.....	<b>8</b>		
Recording on a Single Track.....	<b>9</b>		
Recording on Multiple Tracks .....	<b>9</b>		
Saving .....	<b>9</b>		
<b>Saving a Phrase Memory</b> .....	<b>10</b>		
Saving a Phrase Memory (Write) .....	<b>10</b>		
Deleting a Phrase Memory (Delete) .....	<b>10</b>		
<b>Track 1/2 Settings</b> .....	<b>11</b>		
Adjusting the Track Playback Level .....	<b>11</b>		
Specifying the Track Playback Method.....	<b>11</b>		
Playing a Track Backward (Reverse) .....	<b>11</b>		
Cancelling a Recording/Overdub (Undo) ....	<b>11</b>		
Specifying the Track Playback Method (Loop/One-Shot) .....	<b>11</b>		

## Main Specifications

BOSS RC-202: Loop Station

<b>Recording/ Playback</b>	Maximum Recording Time: Approx. 3 hours (stereo) Maximum Phrase Memory: 8 Memory x 8 Bank Number of Tracks: 2 Data Format: WAV (44.1 kHz, 16-bit linear, stereo)
<b>Power Supply</b>	AC adaptor
<b>Current Draw</b>	400 mA
<b>Dimensions</b>	239 (W) x 175 (D) x 55 (H) mm 9-7/16" (W) x 6-15/16" (D) x 2-3/16" (H) inches
<b>Weight</b>	0.95 kg 1 oz (excluding AC Adaptor)

<b>Accessories</b>	AC adaptor Owner's manual Leaflet "USING THE UNIT SAFELY"
<b>Options (sold separately)</b>	Footswitch: FS-5U, FS-6, FS-7 Expression pedal: Roland EV-5, FV-500L, FV-500H

\* In the interest of product improvement, the specifications and/or appearance of this unit are subject to change without prior notice.

# Overview of the RC-202

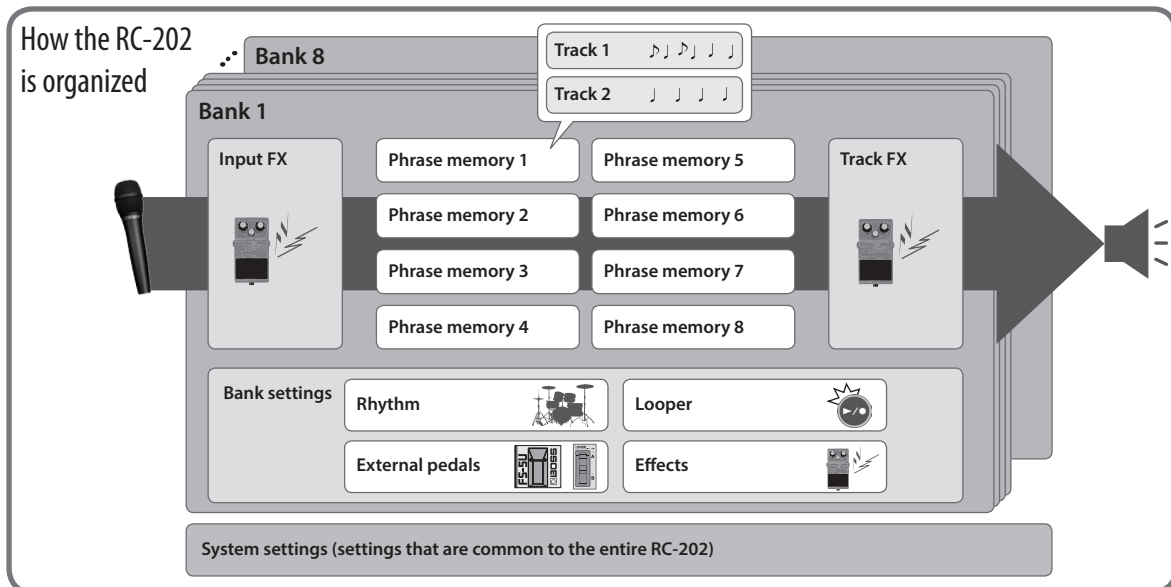

## What are tracks 1 and 2 (p. 11) and phrase memories?

The RC-202 lets you record instrumental or vocal sounds on two “tracks” and play them back. A set of these two tracks is called a “phrase memory.” Up to eight phrase memories can be saved in each bank.

## What is a rhythm? (p. 4)

In addition to the playback of the two tracks, the RC-202 can play “rhythms.” You can record while sounding a rhythm at the tempo you specify.



## What is the Input FX and Track FX? (p. 11)

You can apply effects to the input sound and to the sound of the tracks. These effects are referred to as “Input FX” and “Track FX.”



## What is a bank?

A bank contains phrase memories, input FX settings, track FX settings, and bank settings. The RC-202 has eight banks.

## What are bank settings? (p. 12)

These are each bank’s settings for the rhythm, looper, external pedals, and effects.

## What are system settings? (p. 13)

Settings that are common to the entire RC-202 such as auto-off (automatic power-off), USB, and MIDI are called “system settings.”

## “Recording” versus “Overdub”

In this manual, we refer to the act of recording to an empty track for the first time as **“recording.”** Any subsequent recordings that are made, which are added on top of the existing recording, we refer to as **“overdub.”**

English

日本語

Deutsch

Français

Italiano

Español

Português

Nederlands

# RC-202 Basic Operation Guide

## Specifying How Overdubbing Occurs

You can set the overdub method.

<b>Overdub (Unlit)</b>	The new performance is layered onto the prerecorded tracks. If overdub is repeated, the next performance is layered on top of the previous material, allowing you to create an ensemble in a single track.
<b>Replace (Lit red)</b>	Tracks with existing recordings are overwritten as new tracks are recorded over them.

## Setting the Tempo

Here's how to specify the tempo of the rhythm (the tempo that's common to all phrase memories).

### Tap Tempo

Press the [TAP TEMPO] button several times at intervals of the tempo you want.

Value	40.0–250.0
-------	------------

### Returning to the Original Tempo

If you hold down the [TAP TEMPO] button for two seconds or longer, you'll switch to the tempo that's saved in the phrase memory.

### MEMO

By turning the [VALUE] knob while pressing it, you can adjust the value below the decimal point.

### Adjusting the Tempo

1. Press the [TAP TEMPO] button.
2. Turn the [VALUE] knob to adjust the tempo.

## Sounding a Rhythm

In addition to the playback of the two tracks, the RC-202 can play "rhythms." If you sound a rhythm at a specified tempo while you record, it will help you to keep accurate time.



### Sounding a Rhythm

Press the [RHYTHM START/STOP] button.

### Changing the Rhythm Volume or Settings

- Make settings as described in "Bank Settings" (p. 12).
- Long-press the [RHYTHM START/STOP] button.

page 12

## Recording/Playback/Overdub/Clear

To perform recording, playback, and overdub, press the [▶/●] button as shown in the diagram.

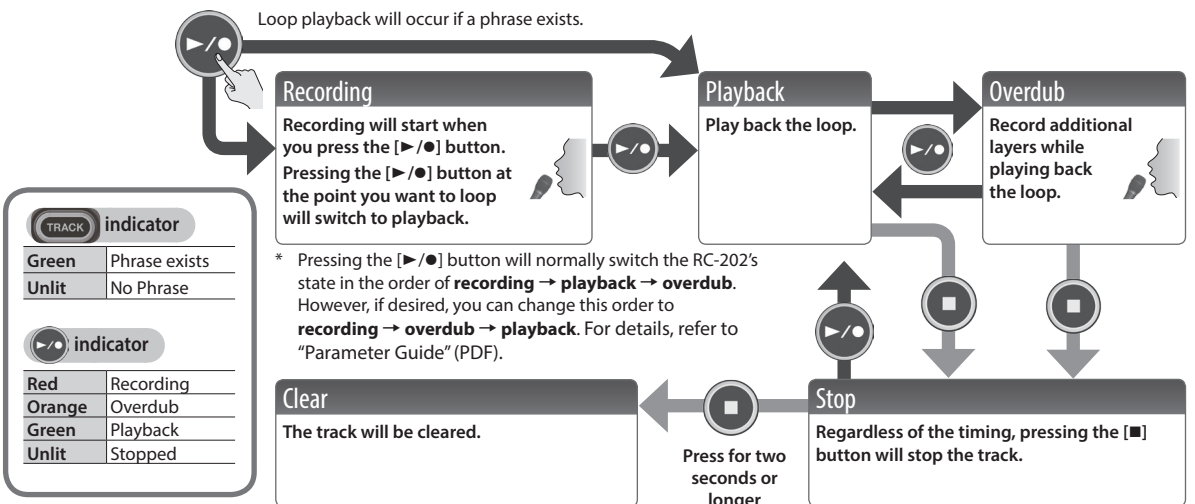

## Setup

You can make bank settings and system settings.

### Bank Settings

page 12

For each bank, you can make settings for rhythm, playback method, and external pedals.

### System Settings

page 13

You can make settings that are common to the entire RC-202, such as auto-off (automatic power-off), USB, and MIDI.

## Adjusting the Input Level

This knob adjusts the input level of your microphone.

page 6

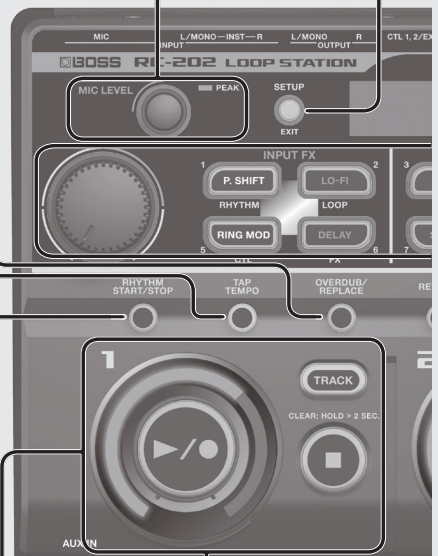

## Selecting a Phrase Memory and Bank

### Selecting a Phrase Memory

1. Press the [MEMORY] button.
2. Use the [P. SHIFT] (1)–[DELAY] (8) buttons to select a phrase memory.

Alternatively,

In the Play screen, turn the [VALUE] knob to select a phrase memory.

### Selecting a Bank

1. Press the [MEMORY] button.
2. Turn the [VALUE] knob to select a bank.
3. Use the [P. SHIFT] (1)–[DELAY] (8) buttons to select a phrase memory.

Alternatively,

In the Play screen, select a bank by turning the [VALUE] knob while pressing it.

## Display

This shows various information according to the operation you're performing.

Startup screen (Play screen)

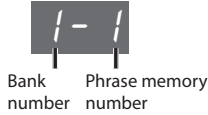

## Saving a Phrase Memory

If you select a different phrase memory or turn off the power after recording or editing the settings, the recorded content or edited settings will be lost. If you want to keep the data, you must save it.

1. Press the [WRITE] button.
2. Use the [P. SHIFT] (1)–[DELAY] (8) buttons to select the save-destination phrase memory.
3. Press the [WRITE] button to save the phrase memory.

page 10

## Input FX, Track FX

You can apply effects to the audio input and to the sound of the tracks, respectively.



### Turning an Effect On

Press the [P. SHIFT]–[DELAY] button to make it light.

### Turning an Effect Off

Press the lit [P. SHIFT]–[DELAY] button to make it go dark.

### Controlling an Effect

Turn the [INPUT FX] / [TRACK FX] knob.

### Editing an Effect

1. Press the [P. SHIFT]–[DELAY] button to make it blink.
2. Turn the [VALUE] knob to select the type.
3. Press the [VALUE] knob to select the parameter; then turn the [VALUE] knob to adjust the value.
4. To select the track to which the effect is applied, press a [TRACK] button to make it blink (track FX only).
5. Press the [SETUP] (EXIT) button to return to the Play screen.

### Effect button indications

Blinking purple *	Editing
Lit purple *	On
Lit red	On
Unlit	Off

\*: Effects for which the [INPUT FX]/[TRACK FX] knobs are operational

## Track Settings

Here you can specify the playback level and playback method of the tracks.

### Adjusting the Playback Level

1. Press the [TRACK] button.
2. Turn the [VALUE] knob to adjust the playback level.

### Specifying the Playback Method

1. Press the button of the function that you want to set.

[REVERSE] button	Specifies either conventional playback or reverse playback.
[UNDO/REDO] button	Here's how to cancel recording/overdubbing for a track.
[LOOP/1 SHOT] button	Specifies either normal loop playback or one-shot playback.

2. Press the [TRACK] button to switch the setting.

page 11

## Input FX

P. SHIFT	This effect lets you change the pitch.
LO-FI	This effect intentionally degrades the sound to create a distinctive character.
RING MOD	Gives a metallic character to the sound, creating the impression that the sound is going out of focus.
DELAY	Adds a delayed sound to the direct sound, giving the sound greater depth or creating special effects.

## Track FX

BEAT	The track plays repeatedly in synchronization with the beat. A filter modifies the brightness or thickness of the sound by cutting a specific frequency range.
FILTER	Repeatedly cuts the sound, transforming a conventional sound to create the impression of a rhythmic backing.
SLICER	Repeatedly cuts the sound, transforming a conventional sound to create the impression of a rhythmic backing.
DELAY	Adds a delayed sound to the direct sound, giving the sound greater depth or creating special effects.

### Reference

For more about the parameters, refer to "Parameter Guide" (PDF).

## Connections

### [POWER] switch

This turns the power on/off.

page 7

### DC IN jack

Connect the included AC adaptor here.

\* Use only the included AC adaptor. Using any other adaptor may cause overheating and malfunction.

### Adjusting the Input Level

Adjust the [MIC LEVEL] knob so that the PEAK indicator occasionally lights orange when the volume is loudest. To adjust the input level of a device that's connected to the INPUT INST jacks or the AUX IN jack, adjust the controls of the connected device.



Color	Input level
Green	Low
Orange	Appropriate
Red	Excessive

### INPUT INST jacks

Connect your effect unit here. Use the L jack and R jack when connecting a stereo-output effects unit. Use only the L jack if you're using a monaural source.

### INPUT MIC jack

Connect your microphone here.   
 ➔ "Phantom Power Setting" (p. 7)   
 \* INPUT MIC jack pin wiring

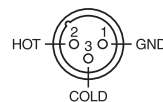

### USB port

You can use a commercially available USB cable to connect the RC-202 to your computer, and use the computer to read/write RC-202 tracks (WAV files).

You can also use the RC-202 to play sound from your computer via USB AUDIO, and use USB MIDI to synchronize the tempo with a DAW that's running on your computer.



page 14

### MIDI connectors

For connecting MIDI device.

page 16

\* To prevent malfunction and equipment failure, always turn down the volume, and turn off all the units before making any connections.

\* Use only the specified expression pedal (Roland EV-5, FV-500H/L; sold separately). By connecting any other expression pedals, you risk causing malfunction and/or damage to the unit.

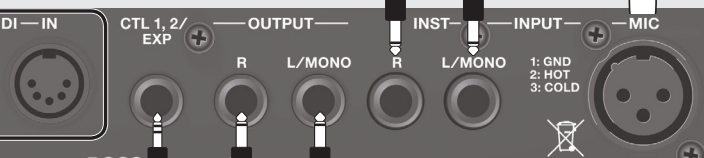

### OUTPUT jacks

Connect these jacks to your amp or monitor speakers. If your system is monaural, use only the L jack. Sound that was input in stereo will also be output monaurally.



### CTL 1, 2/EXP jack



If you connect an expression pedal (Roland EV-5, FV-500H/L; sold separately) or footswitch (FS-5U, FS-7, FS-6; sold separately), you can use it to control a variety of parameters. For details, refer to "Parameter Guide" (PDF).

### Connecting to External Pedals

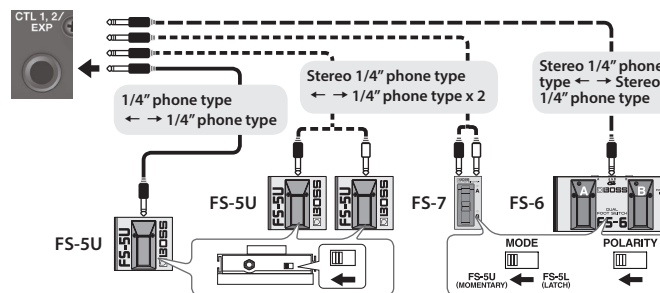

\* If you use a mono cable to connect a single FS-5U, it will be CTL 1.





### AUX IN jack

Use a stereo mini-plug cable to connect your audio player here.

To adjust the input level of the AUX jack, adjust the controls of the connected device (e.g., audio player).



### Phones jack

Connect a set of headphones (sold separately) here.

**MEMO**

You can adjust the volume of the headphones (p. 13).

**Outputting the Rhythm Only to Headphones**

You can use the rhythm as a click tone, and output it only to the headphones. For details, refer to "Parameter Guide" (PDF).



## Turning On the Power

When powering up	Turn on the power to your amp <b>last</b> .
When powering down	Turn off the power to your amp <b>first</b> .

1. Turn the [POWER] switch ON.

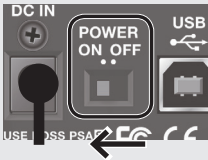

**MEMO**

You can adjust the output volume (p. 13).

**Caution when turning off the power**

**While the RC-202 is in the following states, you must never turn off the power. Doing so may cause all the saved data to be lost.**

- While recording/overdubbing/playing back
- While undoing/redoing
- While switching/saving/deleting a phrase memory
- While a factory reset is in progress
- While connected to a computer

**Caution when using a microphone**

If the speakers and microphone are close together, the sound played back from the speakers may be picked up by the microphone. If you record or overdub in such a state, the speakers playback picked up by the microphone will also be recorded. You should separate the speakers and microphone so that the playback from the speakers is not picked up by the microphone.

## Auto Off Settings

When ten hours have passed since you last played or operated the RC-202, the power turns off automatically (with the factory settings).

If you don't need the power to turn off automatically, turn the Auto Off setting "OFF."

1. Press the [SETUP] button.
2. Press the [DELAY] (GENERAL) button.
3. Press the [VALUE] knob to select "OFF."
4. Turn the [VALUE] knob to change the value.

OFF	The power will not turn off automatically.
ON	The power will automatically turn off when 10 hours have passed since you last played or operated the RC-202.

5. Press the [SETUP] (EXIT) button to complete the setting.

## Phantom Power Setting

If you're using a condenser microphone that requires phantom power, turn phantom power on as described below.

1. Press the [SETUP] button.
2. Press the [BEAT] (I/O) button.
3. Press the [VALUE] knob to select "U48."
4. Turn the [VALUE] knob to select "ON."
5. Press the [SETUP] (EXIT) button to complete the setting.

\* **WARNING: Precautions concerning use of phantom power supply. Always turn the phantom power off when connecting any device other than condenser microphones that require phantom power.**



You risk causing damage if you mistakenly supply phantom power to dynamic microphones, audio playback devices, or other devices that don't require such power. Be sure to check the specifications of any microphone you intend to use by referring to the manual that came with it. (This instrument's phantom power: 48 V DC, 10 mA Max)

## Example of Actual Loop Recording

Let's try loop-recording the following simple 8-beat phrase of vocal percussion (using your voice to imitate the sounds of a drum set) via a microphone.

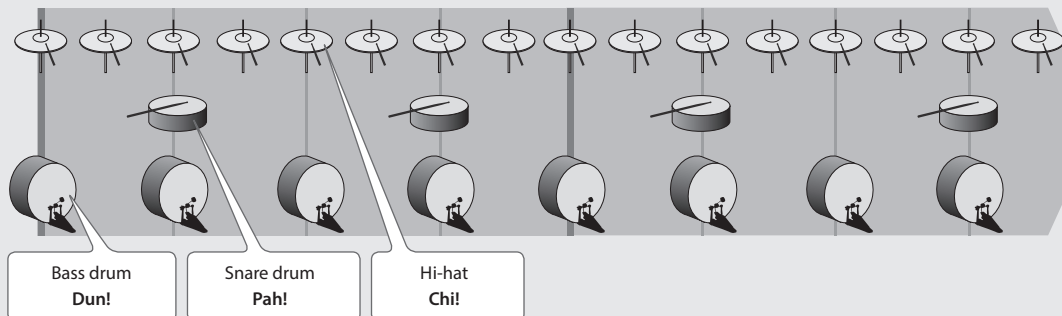

## Preparations

1. Connect your microphone, and adjust the input level ("Adjusting the Input Level" (p. 6)).
2. Select an empty phrase memory (one for which the [TRACK] button is unlit for all tracks) (p. 5).

### Available tracks for recording/overdub

Recording/overdub can be performed on only one track at a time.

For example, if all tracks in the phrase memory are empty, and you're recording track 1, pressing the track 2 [▶/●] button will switch track 1 to playback, and recording will occur on track 2.

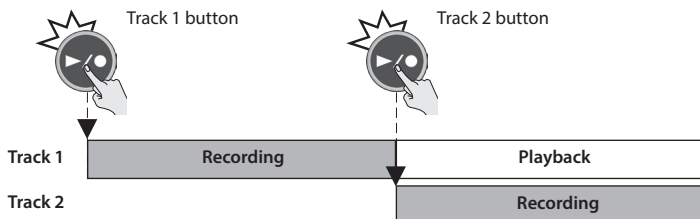

### Switching phrase memories during playback

You can switch phrase memories during playback.

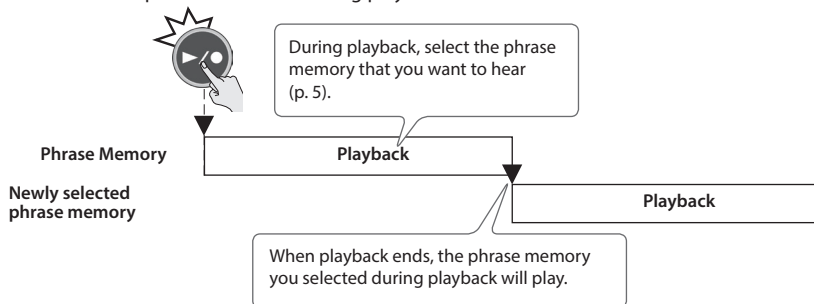

### Applying effects during recording or playback

The RC-202 lets you turn effects on/off during recording or playback, and control the effects in real time. For example if you turn on the track FX FILTER, you can then turn the [TRACK FX] knob to vary the cutoff frequency.





## Recording on a Single Track

With this method, you'll overdub all of the sounds on track 1.

- 1 Press the track 1 [▶/●] button to start recording.
- 2 Record your vocal into the microphone: "Dun! Dun! Dun!..."
- 3 At the end of two measures, press the track 1 [▶/●] button so that loop playback starts at that point.
- 4 Press the track 1 [▶/●] button to start overdubbing.
- 5 Overdub your vocal into the microphone: Pah! Pah! Pah!
- 6 Overdub your vocal into the microphone: Chi! Chi! Chi!
- 7 Press the track 1 [▶/●] button to switch to loop playback.

The sound will automatically start over at the end of the second measure.

## Recording on Multiple Tracks

Record the bass drum sound and snare drum sound on track 1, and the hi-hat sound on track 2. By recording on multiple tracks, you'll have the option of using performance techniques such as stopping just the hi-hat (track 2).

- 1 Press the track 1 [▶/●] button to start recording.
- 2 Record your vocal into the microphone: "Dun! Dun! Dun!..."
- 3 At the end of two measures, press the track 1 [▶/●] button so that loop playback starts at that point.
- 4 Press the track 1 [▶/●] button to start overdubbing.
- 5 Overdub your vocal into the microphone: Pah! Pah! Pah!
- 6 Press the track 2 [▶/●] button; track 2 becomes the recording track.
- 7 Overdub your vocal into the microphone: Chi! Chi!
- 8 Press the track 2 [▶/●] button to loop at that point.

## Saving

When you've finished recording, save the phrase memory.

# Saving a Phrase Memory

## Saving a Phrase Memory (Write)

If you select a different phrase memory or turn off the power after recording or editing the settings, the recorded content or edited settings will be lost. If you want to keep the data, you must save it.

### MEMO

- When you save a phrase memory, the bank settings are also saved automatically.
- You can also save during playback.

### 1. Press the [WRITE] button.



### 2. Use the [P. SHIFT] (1)–[DELAY] (8) buttons to select the save-destination phrase memory.



- This procedure is not required if the phrase memory number is acceptable as is.
- You can't overwrite-save to a phrase memory number in which data is already saved (a phrase memory whose button is lit).
- You can switch the save-destination bank by turning the [VALUE] knob.
- If there's not enough memory to save a phrase memory, the display indicates "E04". If this occurs, delete an unwanted phrase memory and record once again.

### 3. Press the [WRITE] button to save the phrase memory.

If you decide to cancel without saving, press the [SETUP] (EXIT) button.

## Deleting a Phrase Memory (Delete)

Here's how to delete the selected phrase memory.

- \* **The RC-202 contains demo data (bank 8). If you delete this data, it cannot be recovered. Before you proceed, back it up as described in "Backing up to your computer" (p. 15).**

### 1. Hold down the [WRITE] button for at least two seconds.

### 2. Use the [P. SHIFT] (1)–[DELAY] (8) buttons to select the phrase memory that you want to delete.

### 3. Press the [WRITE] button to delete the phrase memory.

If you decide to cancel without deleting, press the [SETUP] (EXIT) button.

### NOTE

- \* Please be aware that the contents of memory can be irretrievably lost as a result of a malfunction or improper operation of the unit. You should back up important data as described in "Backing up to your computer" (p. 15).
- \* All due care is taken during repairs to avoid the loss of data. However, in certain cases, such as when there is damage to the memory, it may not be possible to restore the data.
- \* Unfortunately, it may be impossible to restore the contents of data that was stored in the unit's memory once it has been lost. Roland Corporation assumes no liability concerning such loss of data.

# Track 1/2 Settings

## Adjusting the Track Playback Level

1. Press the [TRACK] button of the track that you want to adjust.  
The button blinks green.



2. Turn the [VALUE] knob to adjust the playback level.

## Specifying the Track Playback Method

1. Press the button of the desired function.

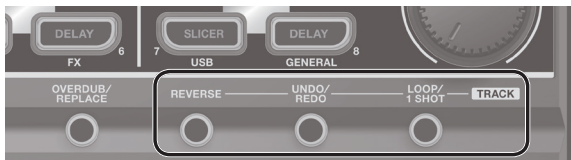

2. Press the [TRACK] button of the track that you want to specify.

### Selecting the track that's controlled by an external pedal

Press the [TRACK] button twice in succession.

The track whose button you press is the track that's controlled by an external pedal.

#### Reference

For more about the functions that can be controlled by an external pedal, refer to "Parameter Guide" (PDF).

Button	[TRACK] button	Explanation	
[REVERSE] button	<b>Playing a Track Backward (Reverse)</b>		
	Specifies whether the track plays normally or in reverse. * If reverse playback is specified, you can't switch to overdubbing when recording ends.		
	Unlit	Normal playback.	
[UNDO/REDO] button	Purple	Reverse playback.	
	<b>Cancelling a Recording/Overdub (Undo)</b>		
	Here's how to cancel recording/overdubbing for a track.		
	1. Press the [UNDO/REDO] button.		
	2. Press the [TRACK] button of the track that you want to undo/redo. * Redo is only available for overdub.		
3. To return to the normal state, press the [UNDO/REDO] button once again.			
	Orange	Undo is available	
	Red	Redo is available	
	Unlit	Undo/redo unavailable	
[LOOP/1 SHOT] button	<b>Specifying the Track Playback Method (Loop/One-Shot)</b>		
	This specifies whether the track plays as a normal loop or as one-shot playback.		
	Track 1	One-Shot: OFF	
	Track 2	One-Shot: ON	
	Unlit	Conventional loop playback.	
	Blue	The phrase will play only once from the beginning to the end of the track, and then stop automatically (One-Shot Playback). If you press the [▶/●] button during playback, playback will begin again from the beginning of the track (Retrigger Playback). Overdub cannot be carried out.	

English

日本語

Deutsch

Français

Italiano

Español

Português

Nederlands

# Bank Settings

For each bank you can make settings for rhythm, looper, external pedals, and effects.

## 1. Select the bank for which you want to make settings.

1. Press the [MEMORY] button.
2. Turn the [VALUE] knob.
3. Use the [P. SHIFT] (1)–[DELAY] (8) buttons to select a phrase memory.

Alternatively,

In the Play screen, turn the [VALUE] knob while pressing it.

## 4. Press the [SETUP] button.

## 5. Press a button to select the category of settings that you want to make.

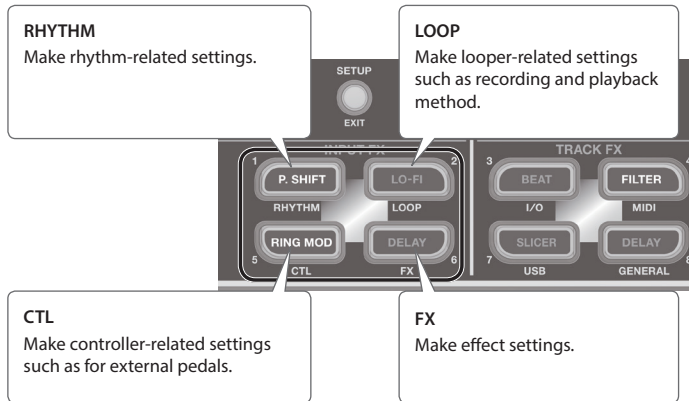

## 6. Press the [VALUE] knob to select a parameter, and turn the [VALUE] knob to edit the value.

### Reference

For details on parameters and rhythm patterns, refer to "Parameter Guide" (PDF).

## 7. Press the [SETUP] (EXIT) button to return to the Play screen.

## Saving a Bank

If you select a different bank or turn off the power after editing the bank settings, your changes will be lost. Be sure to save important data.

## 1. Save any of the phrase memories in that bank (p. 10).

When you save a phrase memory, the bank settings are also saved automatically.

### NOTE

- \* Please be aware that the contents of memory can be irretrievably lost as a result of a malfunction or improper operation of the unit. You should back up important data as described in "Backing up to your computer" (p. 15).
- \* All due care is taken during repairs to avoid the loss of data. However, in certain cases, such as when there is damage to the memory, it may not be possible to restore the data.
- \* Unfortunately, it may be impossible to restore the contents of data that was stored in the unit's memory once it has been lost. Roland Corporation assumes no liability concerning such loss of data.

# Settings for the Entire RC-202 (System Settings)

Settings that apply to the entire RC-202, such as auto-off (automatic power-off), USB, and MIDI, are called “system settings.”

1. Press the [SETUP] button.
2. Press a button to select the category of settings that you want to make.

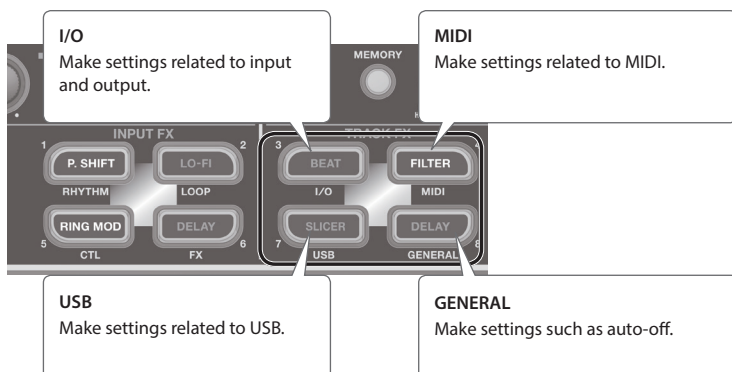

3. Press the [VALUE] knob to select a parameter, and turn the [VALUE] knob to edit the value.

## Reference

For details on the parameters, refer to “Parameter Guide” (PDF).

4. Press the [SETUP] (EXIT) button to return to the Play screen.

## Adjusting the Output Volume of the OUTPUT Jacks and the Headphones

Here’s how to adjust the output volume of the RC-202.

1. Press the [SETUP] button.
2. Press the [BEAT] (I/O) button.
3. Press the [VALUE] knob to select the parameter; then turn the [VALUE] knob to adjust the value.

Parameter	Value	Explanation
$\square L U$	0-100	The output volume of the OUTPUT jacks will be adjusted.
$\square L U$	0-100	The volume of the headphones will be adjusted.

4. Press the [SETUP] (EXIT) button to return to the Play screen.

## Restoring the Factory Settings (Factory Reset)

“Factory reset” is an operation that returns the RC-202’s system settings to their factory-set state. Factory reset can return the system settings to their factory-set state and can also initialize all banks.

\* **The RC-202 contains demo data (bank 8). If you execute factory reset “ALL” or “bB,” the demo data is also erased, and cannot be recovered. Before you proceed, make a backup as described in “Backing up to your computer” (p. 15).**

1. Long-press the [SETUP] (EXIT) button and [MEMORY] button simultaneously.

The Factory Reset range setting screen appears.

2. Use the [VALUE] knob to specify the range of settings that you want to return to their factory-set state.

Value	Explanation
<i>ALL</i>	The system settings will be returned to their factory-set state, and all banks will be erased (initialized)
<i>545</i>	The system settings will be returned to their factory-set state
<i>b 1-bB</i>	The selected bank will be erased (initialized)

\* If you execute “ALL” or “b 1-bB,” the RC-202’s banks will be initialized, and cannot be returned to their previous state.

3. If you want to proceed with the factory reset, press the [WRITE] button.

When the factory reset is completed, you return to the Play screen.

# Connecting to Your Computer via USB

If you use a USB cable to connect the RC-202's USB port to a USB port on your computer, you'll be able to do the following things.



## USB mass storage

You can back up RC-202 tracks (WAV files) to your computer or load WAV files from your computer to the RC-202.

## USB audio/MIDI

You can play your computer's sounds through the RC-202, or record the RC-202's sounds into your computer. You can also use USB MIDI to synchronize the RC-202's tempo to a DAW running on your computer.

### Reference

For more about the RC-202's USB settings, refer to "Parameter Guide" (PDF).

## Installing the USB Driver

In order to use the RC-202's USB audio/MIDI functionality, you must first install the USB driver in your computer (USB mass storage will work even if you don't install the USB driver).

### 1. Install the USB driver in your computer.

You can download the RC-202's dedicated driver from the BOSS website.

#### BOSS website

<http://www.boss.info/support/>

For details on operating requirements, refer to the BOSS website. The program and procedure for installing the driver will depend on the system you're using. Carefully read the downloaded Readme.htm file before you proceed.

## Connecting the RC-202 to a Computer

### 1. Use a USB cable to connect the RC-202's USB port to your computer's USB port (a connector that supports USB 2.0 Hi-Speed).

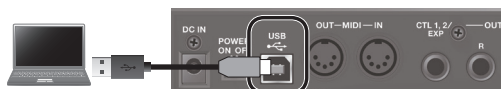

### NOTE

- This might not work correctly on some types of computer. Refer to the BOSS website for details on the supported operating systems.
- Use a USB cable that supports USB 2.0 Hi-Speed operation.

## USB Function Settings

You can specify the USB output destination. For details, refer to "Parameter Guide" (PDF).

## USB audio flow

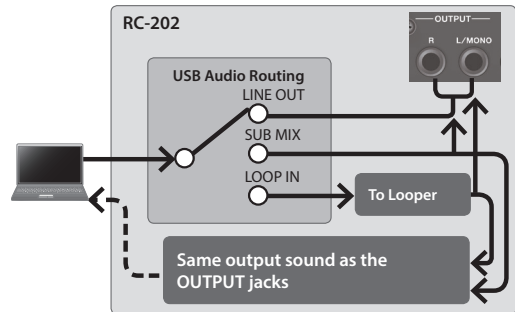

## Using USB to Exchange Files with Your Computer (USB Mass Storage)

You can connect the RC-202 to your computer via a USB cable, and back up RC-202 tracks (WAV files) to your computer or load WAV files from your computer to the RC-202.

## Playable WAV file formats

Data Format	WAV
Bit Depth	16-bit linear, stereo
Sampling Frequency	44.1 kHz

Maximum size per WAV file is 2 GB, maximum time is approximately 3 hours.

1. Press the [SETUP] button.
2. Press the [SLICER] (USB) button.
3. Press the [VALUE] knob to select "nd."
4. Turn the [VALUE] knob to select "NSC."
5. Press the [SETUP] (EXIT) button.
6. Use a USB cable to connect the RC-202's USB port to your computer's USB port (a connector that supports USB 2.0 Hi-Speed).

When the connection to the computer is completed, the message ". . ." appears.

- \* You can't make USB connections if the RC-202 is not stopped, or if there is a phrase that has not been saved.

**7. Back up the data as described below.****Windows users**

Within Computer (or My Computer), open “**BOSS\_RC-202**” (or Removable Disk).

**Mac OS users**

On the desktop, open the “**BOSS\_RC-202**” icon.

**Backing up to your computer**

Copy the entire “**ROLAND**” folder from the BOSS\_RC-202 drive to your computer.

**Recovering backed-up data from your computer to the RC-202**

- \* **Performing this operation will erase all phrase memories that are currently saved in the RC-202. Be sure to make a backup before you proceed.**

In the BOSS\_RC-202 drive, delete the “**ROLAND**” folder, and then copy the backed-up “**ROLAND**” folder from your computer to the BOSS\_RC-202 drive.

**Writing individual WAV files from your computer to the RC-202’s phrase memory**

You can copy WAV files from your computer to the “**001\_1**”, “**001\_2**”–“**064\_1**”, “**064\_2**” folders within the “**ROLAND**”–“**WAVE**” folder in the BOSS\_RC-202 drive (In the folder name “**0XX\_Y**,” the **XX** is the phrase memory number and the **Y** is the track number).

**NOTE**

- \* Do not delete the folders inside the BOSS\_RC-202 drive unless you are performing a recovery operation.
- \* You can use the following characters in file names. A–Z (uppercase letters), 0–9 (numerals), \_ (underscore)
- \* Do not place more than one WAV file in any folder. If a folder already contains a WAV file, do not overwrite it. Write your WAV files into empty folders.

**8. When you’ve finished copying WAV files, disconnect the USB drive as follows.****Windows users**

From the [▲] → [🖱️] icon in the bottom right of the screen, click “Eject BOSS\_RC-202.”

**Mac OS users**

Drag the “**BOSS\_RC-202**” icon to the trash (“Eject” icon).

**9. Press the RC-202’s [SETUP] button.**

The display indicates “*HPE*.”

**10. To disconnect the connection, press the RC-202’s [WRITE] button.****NOTE**

- \* **Never use your computer to format the “**BOSS\_RC-202**” drive.** Doing so will cause the RC-202 to stop operating correctly.

If this occurs, you can return the RC-202 to normal operating condition by executing the “Restoring the Factory Settings (Factory Reset)” (p. 13), **but this will irreversibly erase all phrase memories including the demo data.**

- \* **Never perform the following actions until you have disconnected the USB drive.** Doing so might make your computer freeze, or might result in the loss of all of the RC-202’s data.

- Disconnect the USB cable.
- Allow your computer to enter suspend (standby) or hibernate mode, restart it, or shut it down.
- Turn off the RC-202’s power.

- \* Unfortunately, it may be impossible to restore the contents of data that was stored in the unit’s memory once it has been lost. Roland Corporation assumes no liability concerning such loss of data.



# Connecting an External MIDI Device

## About MIDI Connectors

The MIDI connectors described below are used to transfer MIDI data. Connect MIDI cables to these connectors according to how you're using the RC-202.

Connector	Explanation
MIDI IN	Receives messages from another MIDI device.
MIDI OUT	Transmits messages from this device.



### MEMO

You can use a USB cable to connect the USB port to your computer, and transfer MIDI data to or from the computer via USB MIDI. For details, refer to "Connecting to Your Computer via USB" (p. 14).

## MIDI Settings

### Reference

For more about the RC-202's MIDI settings, refer to "Parameter Guide" (PDF).

- \* Use of MIDI requires that the MIDI channels be matched with those of the connected device. The MIDI channel of the RC-202 is "1" (with the factory settings). Data cannot be transmitted to, nor received from another MIDI device unless the MIDI channels are set properly.

## Controlling an External MIDI Device from the RC-202

Operation	Over View	Explanation
Transmitting Tempo Data and Data for Starting and Stopping Playback	The RC-202's performance tempo data is transmitted to external MIDI devices as MIDI clock.	<p><b>Setting an external MIDI device to the same tempo as the RC-202</b></p> <p>The RC-202 is transmitting MIDI clock messages at all times. In advance, set the external MIDI device so that it can receive MIDI clock and MIDI start/stop messages. For details, refer to the owner's manual of the device you're using.</p>
	Playback start and stop operations with the RC-202's buttons can be transmitted as MIDI Start and Stop messages.	<p><b>Transmitting Start/Stop</b></p> <p>The MIDI start message is transmitted the moment that track playback begins while the track is stopped. The MIDI stop message is transmitted the moment that the track is stopped.</p> <p>* Tracks whose One-Shot setting (p. 11) is "ON" will not transmit start/stop data.</p>
Transmitting Program Change Messages	When a phrase memory is selected with the RC-202, a Program Change message corresponding to the selected phrase memory number is transmitted simultaneously.	<p><b>Transmitting Program Changes</b></p> <p>When you switch phrase memories on the RC-202, a MIDI program change message is transmitted to the connected external MIDI device. The RC-202 can transmit program change numbers 1–64, corresponding to the 64 phrase memories 1-1–8-8.</p> <p>* Set "MIDI Program Change Out" (➔ PDF) to "ON" beforehand.</p> <p>* Program change numbers 65–128 cannot be transmitted.</p> <p>* Bank Select MIDI messages (Control Change #0, #32) cannot be transmitted.</p>

## Controlling the RC-202 from an External MIDI Device

Operation	Over View	Explanation
Receiving Tempo Data and Data for Starting and Stopping Playback	The RC-202 will synchronize to the tempo of MIDI clock data from an external MIDI device.	<b>Setting the RC-202 to the same tempo as an external MIDI device</b> Make settings on your external MIDI device so that it will transmit MIDI clock and MIDI start/stop data. For details, refer to the owner's manual of your device. Set the RC-202's MIDI sync ( ➔ PDF) to "AUTO." * You can't switch the tempo during recording.
	Start/stop data will be received from an external MIDI device to play/stop the RC-202.	<b>Receiving MIDI start</b> When a MIDI start (FA) message is received, all tracks play. When a MIDI stop (FC) message is received, all tracks stop.
Switching Phrase Memory Numbers	The RC-202's phrase memories switch simultaneously upon receipt of corresponding Program Change messages from external MIDI devices.	<b>Switching Phrase Memories</b> You can switch the RC-202's phrase memories with Program Change messages from external MIDI devices. The RC-202 can receive program change numbers 1–64, corresponding to the 64 phrase memories 1-1–8-8. * Nothing happens if a program change number 65–128 is received. * Even if received, Bank Select MIDI messages (Control Change #0, #32) are disregarded.
Receiving Control Change Messages	The RC-202 can be controlled using Control Change messages from external MIDI devices.	<b>Receiving control change messages</b> You can use control change messages from an external MIDI device to control functions that would be difficult to control using the RC-202's own controllers. In "Controller Settings (CTL Source)" ( ➔ PDF), select "CC#80–#84" and use "Specify Control Target (CTL Target)" ( ➔ PDF) to specify the parameter that you want to control.

## Connecting Two RC-202 Units

Two RC-202 units can be synchronized after connecting them together using a MIDI cable.

- Use a commercially available MIDI cable to make the following connection.

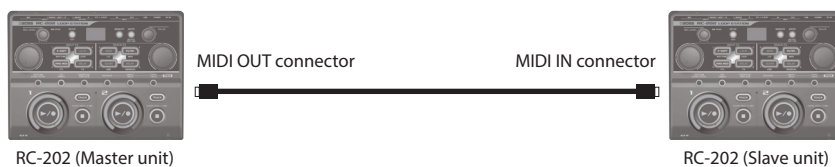

- Begin recording on the master RC-202 unit's tracks.

# Troubleshooting

Problem	Items to Check	Action	Page
<b>Problems with Sound</b>			
No sound/low volume	Are the connection cables shorted?	Try replacing the connection cable.	–
	Is the RC-202 properly connected to other devices?	Check the connections to other devices.	p. 6
	Is the power to the connected amp or mixer not turned on, or is the volume turned down?	Check the settings for connected devices.	–
	Could the following levels be lowered? • Track play level • Output level	Adjust each level. Check whether an external expression pedal might have been used to adjust the level.	p. 11 p. 13 ➔ PDF
	Has anything been recorded to the tracks?	Look at the track's [TRACK] button to see whether it has been recorded. If the [TRACK] button is unlit, the track has not been recorded.	p. 4
No rhythm sound	Is the rhythm line out set correctly?	Check the Rhythm Line Out setting.	➔ PDF
	Could the rhythm level be lowered?	Adjust the Rhythm Level.	➔ PDF
Sound is missing from the beginning and end of the recorded track	To prevent noise, a fade-in and a fade-out are applied at the beginning and end of a recording. In some cases, it may sound as if some of the sound has been left out.		–
Unable to hear sounds from device connected to AUX/INST/MIC jacks	Could the [MIC LEVEL] knob be lowered?	Adjust knobs to the suitable positions.	p. 6
	Could the volume of the connected device be lowered?	Adjust the level appropriately.	–
	Could the system setting input line out be "OFF"?	Set the Input Line Out to "ON."	➔ PDF
<b>Problems with Operation</b>			
Phrase memories not switching	Is something other than the Play screen appearing in the display?	The RC-202 cannot switch phrase memories except when in the Play screen. Press the [SETUP] (EXIT) button to return to the Play screen.	p. 5
Recording/overdub stops before finishing	Is there insufficient memory remaining?	If memory is insufficient, delete any unneeded phrase memories before recording or overdub.	p. 10
Playback tempo not changing	Is recording or overdub in progress?	You cannot change the phrase memory tempo during recording or overdub. Change the tempo while the performance is stopped or being played back.	p. 4
	Is the RC-202 synchronized via MIDI?	If MIDI clock messages are being received via the MIDI IN connector or the USB port, the RC-202 synchronizes its tempo to MIDI clock. If you don't want to synchronize with an external device, set MIDI sync to "INTERNAL."	➔ PDF
MIDI messages not being transmitted/received	Are the MIDI channels matched to those of the external MIDI device?	Confirm that both devices are set to the same MIDI channels.	–
	If transmitting from the RC-202, have you made the necessary settings for transmission?	Check the program change message transmit on/off setting.	–
<b>Problems with USB</b>			
Unable to communicate with computer	Is the USB cable properly connected?	Check the connection.	p. 14
	(If exchanging files with your computer via USB) Is the USB Mode set to "MSC"?	As described in "Using USB to Exchange Files with Your Computer (USB Mass Storage)" (p. 14), set USB Mode to "MSC."	p. 14
Unable to import WAV file	Are the file name and format of the WAV file correct?	Check the file name and format of the WAV file.	p. 15

## Error Message List

Display	Meaning	Action
E01	Playback is not possible because the recording time or WAV file is too long.	The recording time or WAV file length must not exceed three hours.
E02	Playback is not possible because the recording time or WAV file is too short.	The recording time or WAV file length must be at least 0.1 seconds.
E03	Further overdub is not possible.	Save the phrase again.
E04	The maximum recording time is approximately three hours (total of all phrase memories). If the maximum recording time is exceeded, recording or overdubbing might be interrupted because of insufficient internal memory.	Delete unneeded phrase memories (p. 10), and then try recording again.
E05	An excessive volume of MIDI messages were received and could not be processed properly.	Reduce the number or size of MIDI messages transmitted to the RC-202.
E06	MIDI messages could not be properly received.	Check to make sure that no corrupt MIDI messages are being transmitted. Reduce the number or size of MIDI messages transmitted to the RC-202.
E07	There is a problem with the MIDI cable connection.	Check to make sure the cable has not been disconnected and that there is no short in the cable.
E08	When saving a phrase memory, you can't overwrite a phrase memory in which data was already saved.	Select an empty phrase memory, and then save (p. 10).
E09	The procedure cannot be carried out unless the unit is in the stopped state.	Stop the unit, then try the procedure again.
E10	Since the track is being played at a much faster tempo than when it was recorded, it might not play back correctly.	Adjust the tempo.
E11	Since the track is being played at a much slower tempo than when it was recorded, it might not play back correctly.	
E12	This WAV file is unplayable.	Check the format of the WAV file.
E90	The RC-202 could not process the data completely.	Lower the performance tempo. Save the current content to a phrase memory. Reduce the number of adjustments or changes made with the RC-202's knobs and external pedals. Reduce the number or size of MIDI messages transmitted to the RC-202. Ensure that the phrase is not shorter than 0.1 seconds.
E91	It may be that an invalid file was written while connected in USB mass storage mode (e.g., when writing a WAV file). Alternatively, you used your computer to format the "BOSS_RC-202" drive when connected in USB mass storage mode, causing the RC-202 to stop operating correctly.	In factory reset (p. 13), select "RL L" to return the RC-202 to its factory-set condition.
E97	A problem has occurred with the content of the RC-202's memory.	Consult your Roland dealer or local Roland Service.
E98		
E99	A problem has occurred in the system.	Consult your Roland dealer or local Roland Service.

English

日本語

Deutsch

Français

Italiano

Español

Português

Nederlands

# USING THE UNIT SAFELY

## WARNING

### Concerning the Auto Off function

The power to this unit will be turned off automatically after a predetermined amount of time has passed since it was last used for playing music, or its buttons or controls were operated (Auto Off function). If you do not want the power to be turned off automatically, disengage the Auto Off function (p. 7).



### Use only the supplied AC adaptor and the correct voltage

Be sure to use only the AC adaptor supplied with the unit. Also, make sure the line voltage at the installation matches the input voltage specified on the AC adaptor's body. Other AC adaptors may use a different polarity, or be designed for a different voltage, so their use could result in damage, malfunction, or electric shock.



## CAUTION

### Precautions concerning use of phantom power supply

Always turn the phantom power off when connecting any device other than condenser microphones that require phantom power. You risk causing damage if you mistakenly supply phantom power to dynamic microphones, audio playback devices, or other devices that don't require such power. Be sure to check the specifications of any microphone you intend to use by referring to the manual that came with it. (This instrument's phantom power: 48 V DC, 10 mA Max)



## IMPORTANT NOTES

### Placement

- Depending on the material and temperature of the surface on which you place the unit, its rubber feet may discolor or mar the surface.

### Repairs and Data

- Before sending the unit away for repairs, be sure to make a backup of the data stored within it; or you may prefer to write down the needed information. Although we will do our utmost to preserve the data stored in your unit when we carry out repairs, in some cases, such as when the memory section is physically damaged, restoration of the stored content may be impossible. Roland assumes no liability concerning the restoration of any stored content that has been lost.

### Additional Precautions

- Any data stored within the unit can be lost as the result of equipment failure, incorrect operation, etc. To protect yourself against the irretrievable loss of data, try to make a habit of creating regular backups of the data you've stored in the unit.
- Roland assumes no liability concerning the restoration of any stored content that has been lost.
- Use only the specified expression pedal (Roland EV-5, FV-500H/L; sold separately). By connecting any other expression pedals, you risk causing malfunction and/or damage to the unit.

- Do not use connection cables that contain a built-in resistor.

### Intellectual Property Right

- It is forbidden by law to make an audio recording, video recording, copy or revision of a third party's copyrighted work (musical work, video work, broadcast, live performance, or other work), whether in whole or in part, and distribute, sell, lease, perform or broadcast it without the permission of the copyright owner.
- Do not use this product for purposes that could infringe on a copyright held by a third party. We assume no responsibility whatsoever with regard to any infringements of third-party copyrights arising through your use of this product.
- The copyright of content in this product (the sound waveform data, style data, accompaniment patterns, phrase data, audio loops and image data) is reserved by Roland Corporation.
- Purchasers of this product are permitted to utilize said content (except song data such as Demo Songs) for the creating, performing, recording and distributing original musical works.

- Purchasers of this product are NOT permitted to extract said content in original or modified form, for the purpose of distributing recorded medium of said content or making them available on a computer network.
- MMP (Moore Microprocessor Portfolio) refers to a patent portfolio concerned with microprocessor architecture, which was developed by Technology Properties Limited (TPL). Roland has licensed this technology from the TPL Group.
- The SD logo () and SDHC logo () are trademarks of SD-3C, LLC.
- ASIO is a trademark and software of Steinberg Media Technologies GmbH.
- This product contains eParts integrated software platform of eSOL Co.,Ltd. eParts is a trademark of eSOL Co., Ltd. in Japan.
- Roland, BOSS and LOOP STATION are either registered trademarks or trademarks of Roland Corporation in the United States and/or other countries.
- Company names and product names appearing in this document are registered trademarks or trademarks of their respective owners.